

# mi-move

— MOVING MADE EASY



Lower Road, Sutton

£1,675 pcm



This bright and very spacious, first floor purpose built flat is located in a popular block within walking distance of Sutton High Street and all its supermarkets and shops. The property has a large dual aspect lounge/diner and is available to let immediately.

The property is reached through a communal entrance and stairs to its private entrance on the first floor. As you walk through the front door you enter a large hall with space for shelving in addition to the two built in storage cupboards. The hall gives access to the bathroom and bedrooms and leads into the lounge/diner which has more than enough space for a dining table and chairs in addition to a sofa set.

The kitchen is fitted with a good range of modern units and includes a split level electric oven and gas hob, fridge freezer and washing machine.

Both bedrooms are spacious with the smaller being a much bigger than a normal single bedroom. The bathroom is well fitted with a modern suite with a full sized bath with an electric power shower and shower screen. The property has gas central heating and is fully double glazed.

The property is set back from the road behind its own security gates and there are communal gardens with an allocated parking space to the rear of the block. Don't miss this opportunity - contact us now for your appointment.







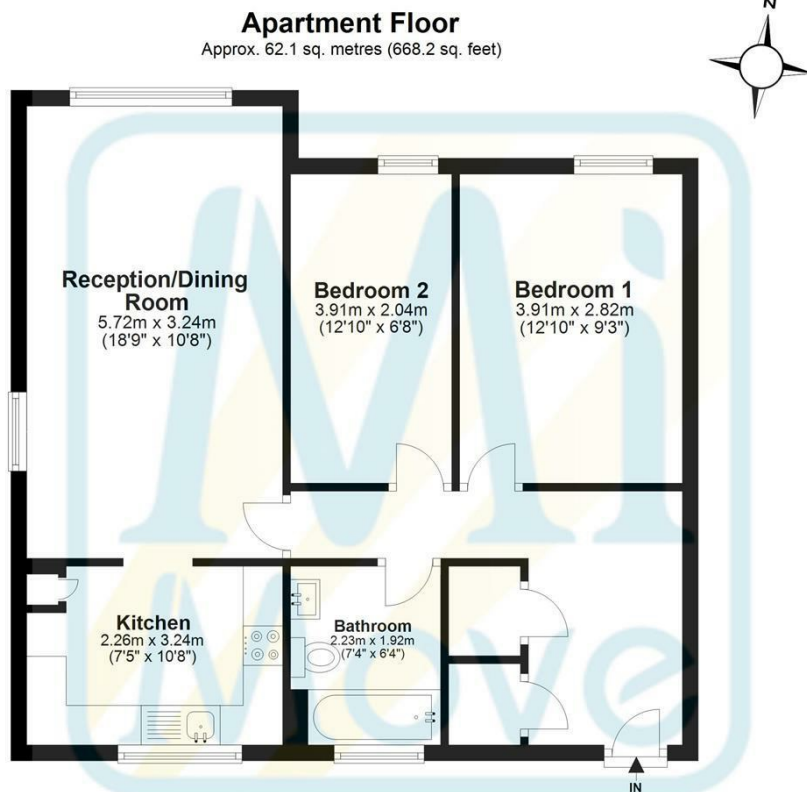

Total area: approx. 62.1 sq. metres (668.2 sq. feet)

Floor Plan measurements are approximate and are for illustrative purposes only. While we do not doubt the floor plans accuracy, we make no guarantee, warranty or representation as to the accuracy and completeness of the floor plan.  
Plan produced using PlanUp.

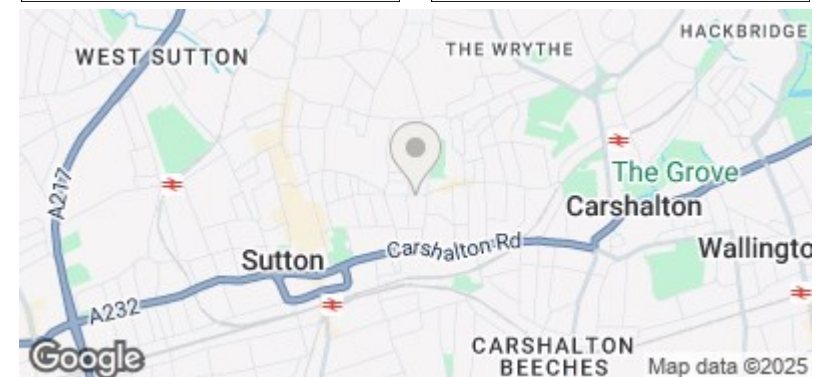
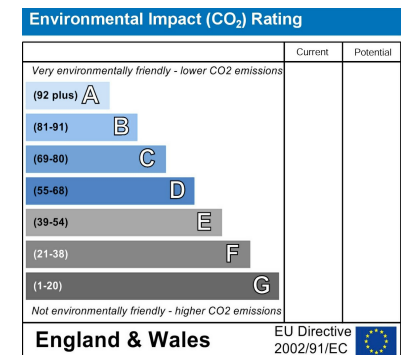
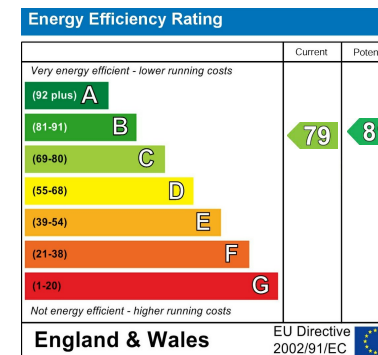

Mi-Move Limited, 6 Sutton Plaza, Sutton Court Road, Sutton, Surrey SM1 4FS

**Phone:** 020 3538 0558 **Email:** info@mi-move.com **Web:** www.mi-move.com

**Registered in England No:** 07979632 **VAT No:** 132 0989 20

