



26 Keogh Road
London, E15 4NR
£4,000 Per Month



26 Keogh Road, London, E15 4NR

Presenting a spacious 5-bedroom house featuring a paved garden, reception room, and kitchen. The property includes a downstairs WC and a family bathroom on the 1st floor. Recently fitted with new carpets throughout, it comes fully furnished, ready for immediate occupancy.

Nestled in a serene residential road, the house offers tranquility while being just moments away from Maryland Station. Exceptional transport links are within walking distance to both Maryland and Stratford Stations. Additionally, Westfield Shopping Centre, with its diverse range of shops, bars, and restaurants, is in proximity, along with the Queen Elizabeth Park.

This residence is an ideal family home, offering a perfect blend of comfort and convenience. To secure your chance, book your viewings promptly, as this property is anticipated to be in high demand.

Council Band C
EPC RATING D
Available for a group of sharers.



Area Map

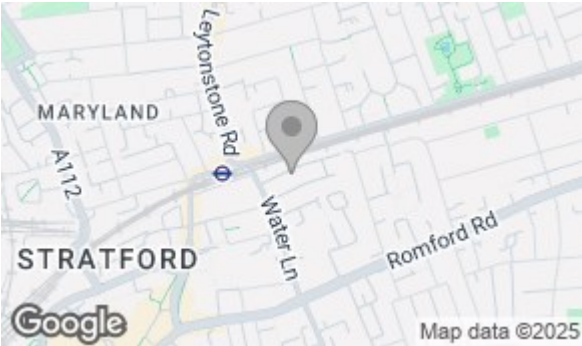

Floor Plan

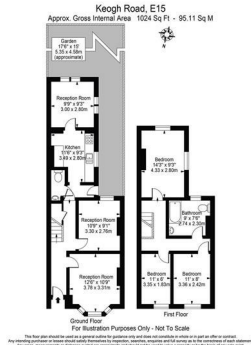

Energy Efficiency Graph

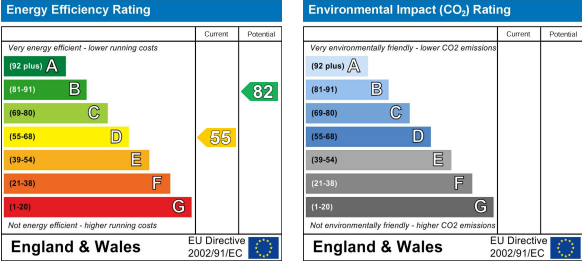

These particulars, whilst believed to be accurate are set out as a general outline only for guidance and do not constitute any part of an offer or contract. Intending purchasers should not rely on them as statements of representation of fact, but must satisfy themselves by inspection or otherwise as to their accuracy. No person in this firms employment has the authority to make or give any representation or warranty in respect of the property.