

Apartment

FLAT 514 ROMNEY HOUSE 47 MARSHAM STREET, LONDON, SW1P 3DS

FEATURES

- Lift
- Gymnasium
- Parking Space
- Porter
- Spa Facilities
- Available 1st September 2025



TUCKERMAN
ESTATE AGENTS
PROPERTY PROFESSIONALS

2 Bedroom Apartment located in London

An immaculately presented two bedroom, one bathroom apartment on the fifth floor of this modern development in the heart of Westminster.

Call us on
020 7222 5510
info@tuckermanresidential.co.uk
www.tuckermanresidential.co.uk

Council Tax Band
F

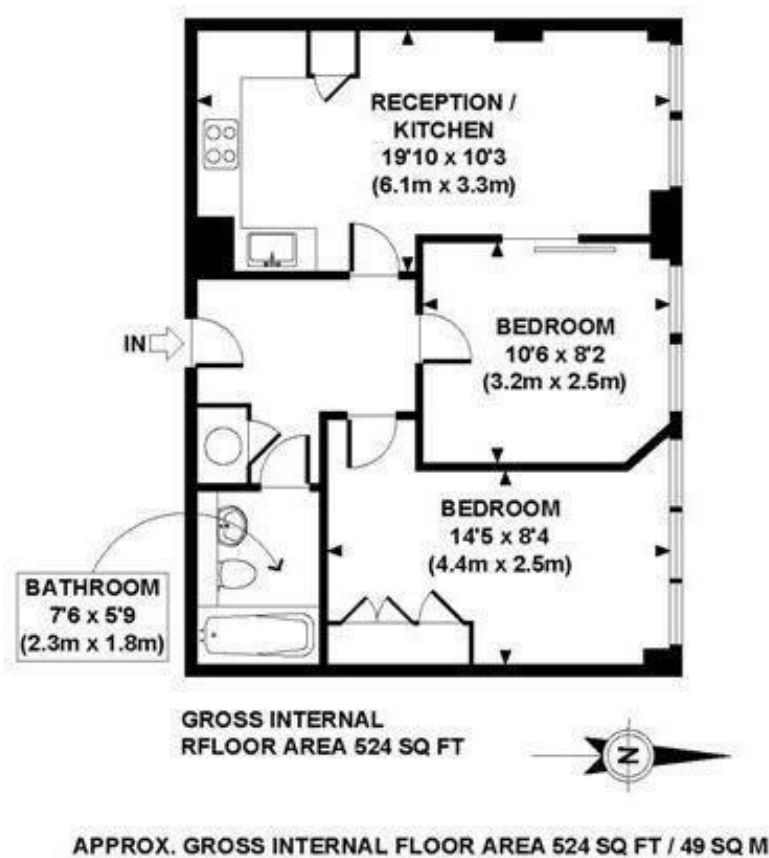

Energy Efficiency Rating		
	Current	Potential
Very energy efficient - lower running costs		
(92 plus) A		
(81-91) B		
(69-80) C		
(55-68) D		
(39-54) E		
(21-38) F		
(1-20) G		
Not energy efficient - higher running costs		
England & Wales		EU Directive 2002/91/EC

Agents Note: Whilst every care has been taken to prepare these particulars, they are for guidance purposes only. All measurements are approximate and are for general guidance purposes only and whilst every care has been taken to ensure their accuracy, they should not be relied upon and potential buyers are advised to recheck the measurements.