







Adam Hayes - North Finchley Office - Lettings 365 Ballards Lane, North Finchley, London, N12 8LL

Tel: 020 8445 4008 Email: [info@adam-hayes.co.uk](mailto:info@adam-hayes.co.uk) Web: [www.adam-hayes.co.uk](http://www.adam-hayes.co.uk)

Dale Grove, London, N12 8EG

£1,400 PCM

 1 Bedrooms  1 Bathrooms  1 Receptions

## Key Features

- One Bedroom Purpose Built Flat
- Top Floor
- Approx. 14ft Lounge
- Fitted Wardrobes
- Great Location
- Gas Central Heating
- Double Glazed Windows

## Other Information

Council Tax Band: C

Length of Tenancy: Long Let

Deposit: £1,615

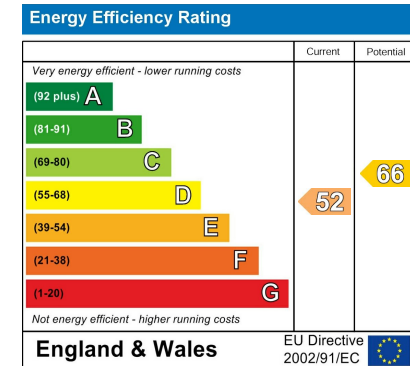

## Nearest Stations

- West Finchley

## Property Description

A well-proportioned one-bedroom apartment, ideally positioned on the top (second) floor of a purpose-built block, located within this sought-after residential turning just off Ballards Lane. The property offers a generous 14ft reception room, a new kitchen, boiler and sink in the bathroom, fitted wardrobes, excellent storage options, double glazing, and gas central heating. Conveniently situated within close proximity to West Finchley Underground Station, a range of supermarkets, local cafés, coffee shops, and a variety of shopping facilities, as well as the open green spaces of Victoria Park. An internal viewing is highly recommended to fully appreciate the space and superb location on offer.

Adam Hayes - North Finchley Office - Lettings 365 Ballards Lane, North Finchley, London, N12 8LL

Tel: 020 8445 4008 Email: [info@adam-hayes.co.uk](mailto:info@adam-hayes.co.uk) Web: [www.adam-hayes.co.uk](http://www.adam-hayes.co.uk)

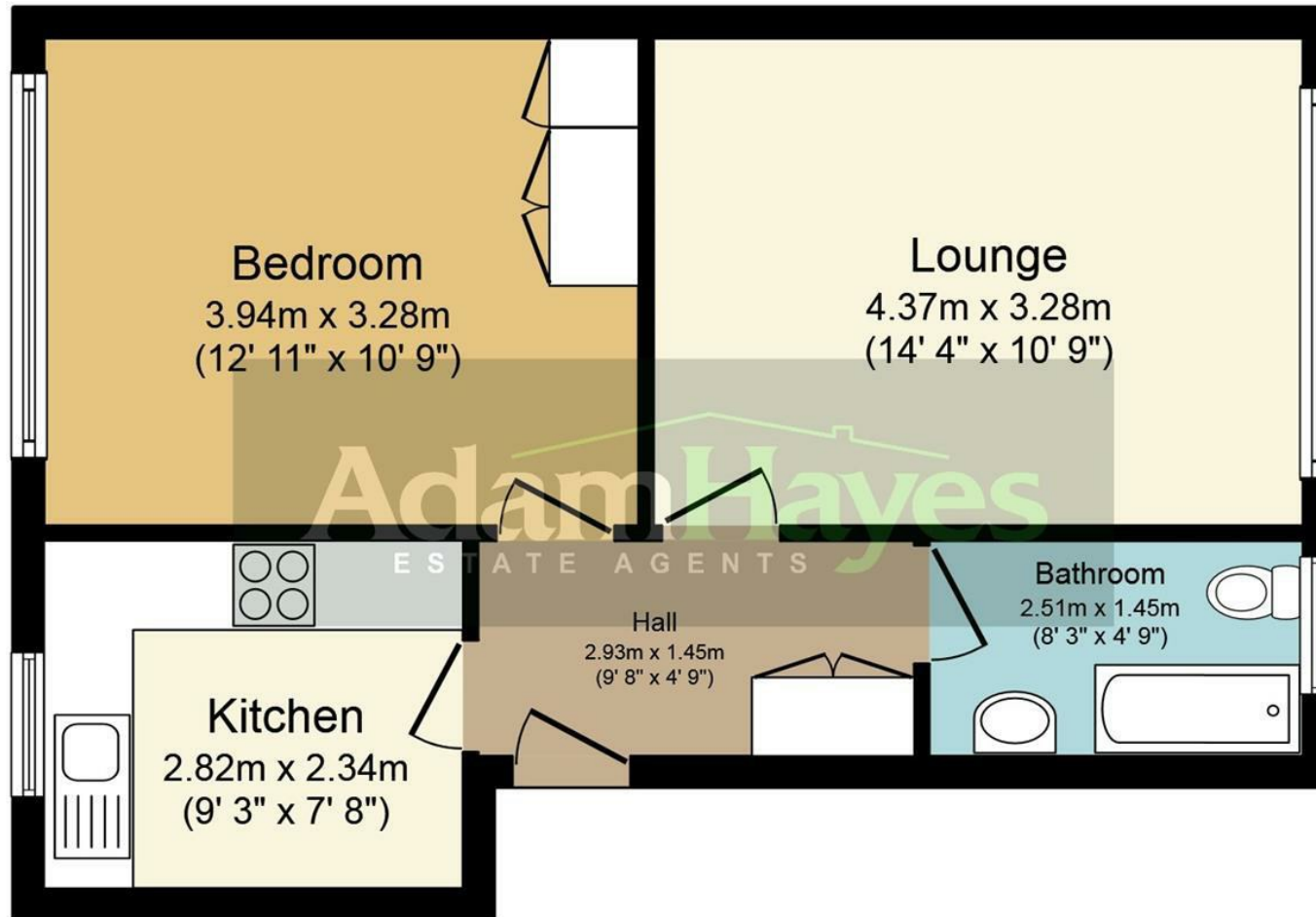

## Floor Plan

Total floor area 43.4 sq.m. (467 sq.ft.) approx

This plan is for illustration purposes only and may not be representative of the property. Plan not to scale.

These particulars, whilst believed to be accurate, are set out as a general outline only for guidance and do not constitute any part of an offer or contract. Intending purchasers or prospective tenants should not rely on them as statements or representation of fact, but must satisfy themselves by inspection or otherwise as to their accuracy. We have not carried out a detailed survey, not tested the services, appliances and specific fittings. Room sizes should not be relied upon for carpets and furnishings. The measurements given are approximate. No person in this firm's employment has the authority to make or give any representation or warranty in respect of the property.