



11-13, Sloane Court West,
Chelsea, SW3

£1,550 Per Week,

NAPIER WATT

T: 0207 935 0011
E: enquiries@napierwatt.co.uk
W: napierwatt.co.uk

35 Berkeley Square, Mayfair, London, W1J 5BF







Description

Generously-sized, two-bedroom apartment, designed in a traditional style. The quality of finish throughout this quintessential Chelsea apartment is exceptional. Set on the second floor of a desirable red-brick mansions block the property benefits from a lift and high ceilings. The accommodation of approximately 1,440sq ft (134sq m) comprises a vast living room, an elegant dining room, modern fitted kitchen, master en-suite, second double bedroom and a family bathroom. This home benefits from a on-site caretaker and is a short walk from Sloane Square and it's transport links, as well and the shops, bars and amenities of the Kings Road. Available now, furnished.

2 Bedrooms : 2 Bathrooms : Lift : Caretaker

Key Features

- BEAUTIFULLY PRESENTED
- CARETAKER
- LATERAL TWO-BEDROOM
- PASSENGER LIFT
- SPACIOUS ACCOMMODATION

Terms

Fees & Charges: Tenancies exceeding £100,000 Per annum £480 inc VAT, Tenancies where a company is a tenant £480 Inc VAT.

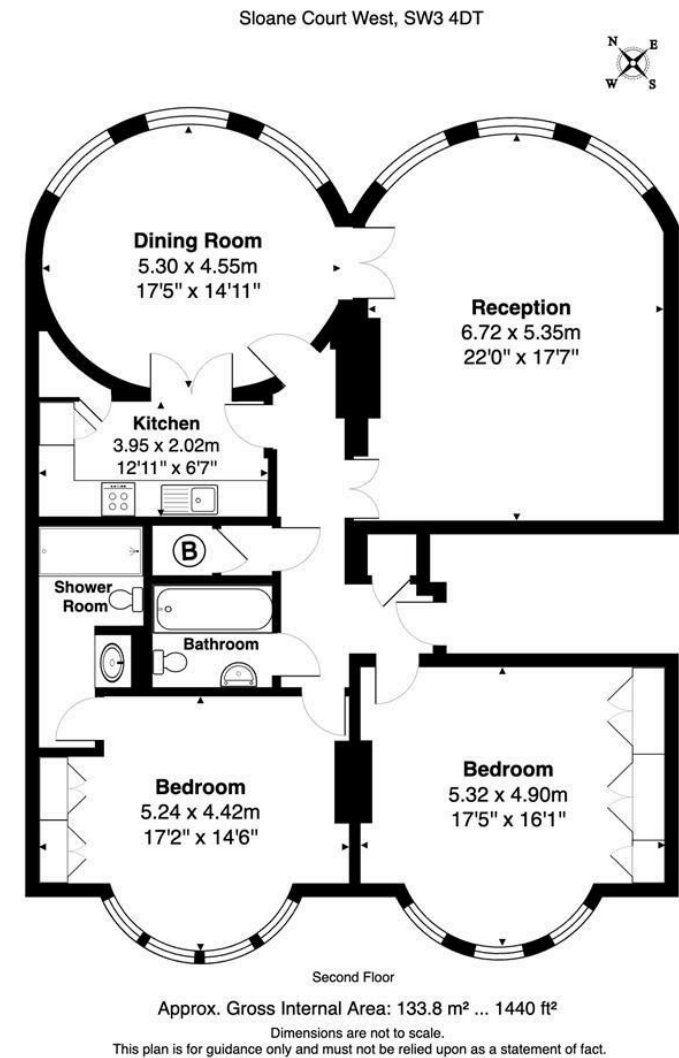

IMPORTANT: We would inform prospective purchasers that these sales particulars have been prepared as a general guide only. A detailed survey has not been carried out, nor the services, appliances and fittings tested. Room sizes should not be relied upon for furnishing purposes and are approximate. If floor plans are included, they are for guidance only and illustration purposes only and may not be to scale. If there are any important matters likely to affect your decision to buy, please contact us before viewing the property.